

# Dismissal Procedure for Pick-ups

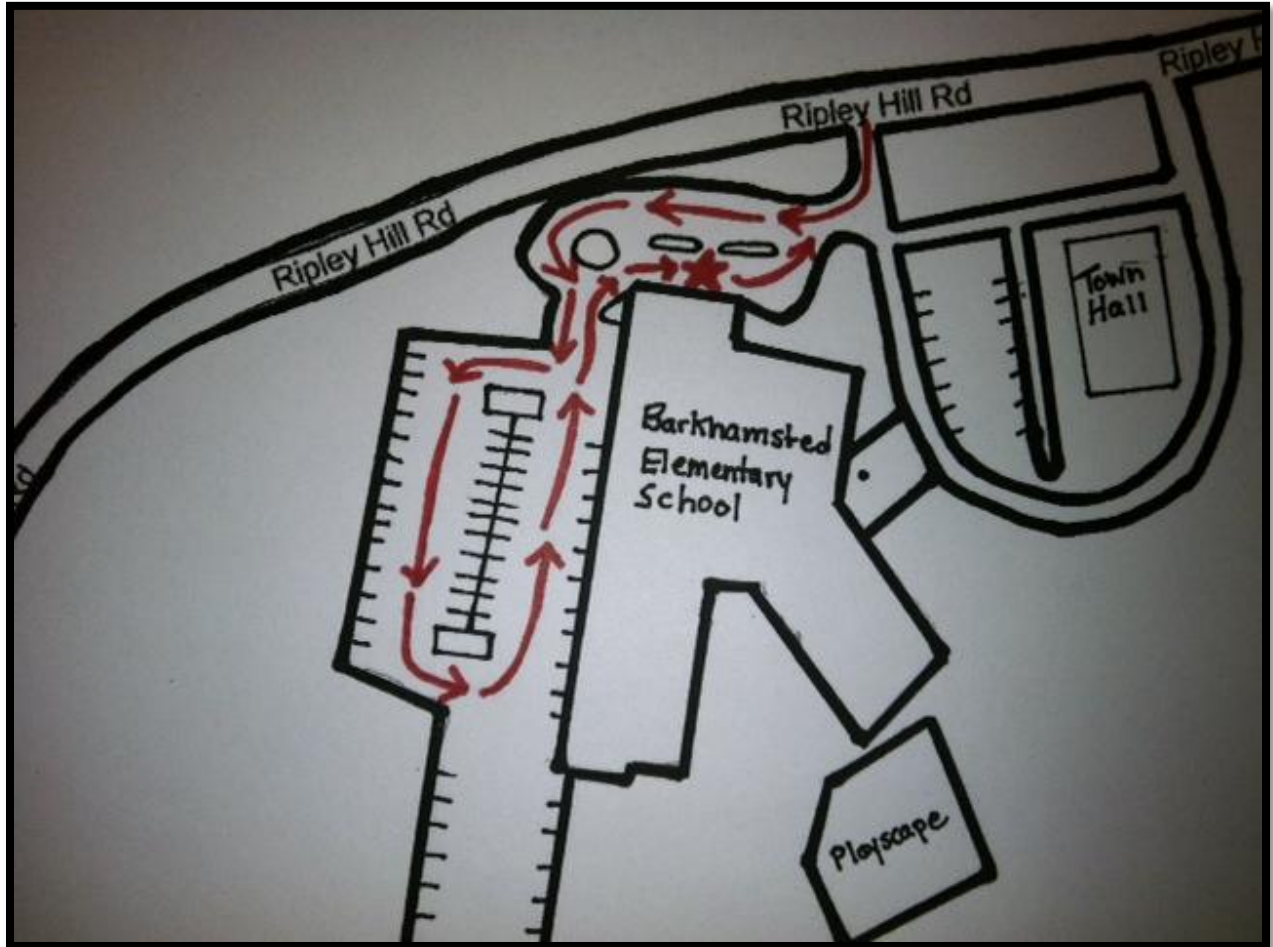

Enter the parking lot, stay to the right as you drive around. Continue around the park lot until the line begins outside the old school entrance outside the Kindergarten wing. Cones and signs will mark the "pick-up zone." Do not line-up until 3:10pm. Roll down passenger window to tell the staff member who you are picking up. They will assist the student into your car.